

S/Y K-35 Lagoon 40



SPECIFICATIONS

Length: 11.74m (38'6")

Beam: 6.76m (22'2")

Draft: 1.35 m (4' 5")

Number of crew: 1-2 (optional)

Built: 2018

Builder: Lagoon

Flag: Phuket, Thailand

Main Sail: 511 sqm

Genoa / Jib: 364 sqm

Cruising Speed: 6 / 8 kn

Water Tank: 300 liters

Fuel Tank: 2x200 liters

EQUIPMENT

Engines: Yanmar 2 x 45 hp

Panda Generator

Inverter 12V/ 220V

Watermaker (63L)

Air condition, fans in salon, galley and all cabins

USB sockets in all cabins

Refrigerator

Additional fridge in Galley (100L)

Quiet flush electrical toilets (2 heads)

ACCOMMODATION

Number of cabins: 4+2

Cabin configuration: 4 Double, 2 Bow Compartments

Bed configuration: 4 Double, 2 Single & Double berth in salon

Number of guests: 10+2

WATER SPORTS

Tenders + toys:

Dinghy and outboard, Snorkeling Gears

This new model of Lagoon 40 looks more like her 50-foot sister model: featuring angular transoms, larger rectangular wrap-around windows and a coachroof that flows into an upwards-angled composite Bimini.

The foredeck has been added some softness to cover up on the deck hatches, the sun lounging cushions. Making it a perfect spot to curl up with a book or cocktail. You may easily pass refreshments from the salon to the foredeck, through the large porthole at the salon's front window; can well save you a trip from the foredeck all the way to the galley.

From the cockpit, steps lead up to the starboard-side helm, which is nicely integrated so the driver is separate but not alone. The helm opens to the starboard side deck so you can easily step out and lend a hand with dock lines or anchoring. Her transoms are squared off with two low steps leading up from the swim platforms to the cockpit, enables easy access from the pontoon if the boat is moored sideways.

Despite her size, her interior is no compromises of space and cozy touch wood veneers and leather-like panels. The salon and galley on the main deck remains the similar layout of other Lagoon families. In the galley there are three-burner stove, under-counter front-loading refrigerator and cookware stowage in the aft port corner; to starboard is an additional refrigerator and overhead are provisions lockers. A small navigation desk is tucked into the forward port corner and is equipped with a multi-function display and instruments. The standard L shape sofa allows easy flow of traffic inside the salon.

Both hulls are equipped with two double cabins that share a head with a large stall shower. With two bunk beds in the bow compartments and the double berth space convertible in the salon, she's able to accommodate 12 guest for bareboat charters, or 10 guests with 2 crew.



Top view



Cockpit



Cockpit



Helm



Salon



Salon



Cabin



V



Cabin



Head



cabine / cockpit, if saloon / cockpit

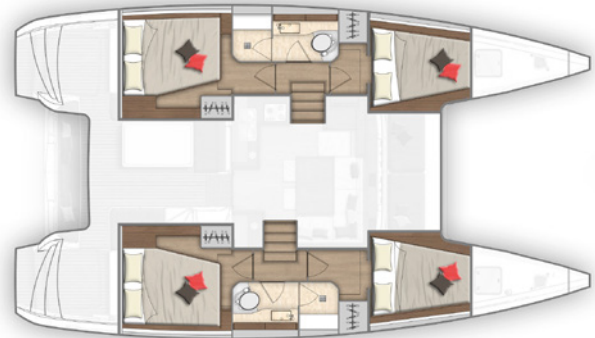

4 cabines 2 Salles de bain / 4 cabins 2 bathrooms

This document is not contractual. All specifications are given in good faith and offered for informational purposes only. The publisher and company do not warrant or assume any legal liability or responsibility for the accuracy, completeness, or usefulness of any information and/or images displayed. Yacht inventory, specifications and charter prices are subject to change without prior notice. None of the text and/or images used in this brochure may be reproduced without written consent from the publisher.